

IND200 隐藏式内平开下悬系列

IND200 The Features for Concealed Turn-and-Tilt Window Series

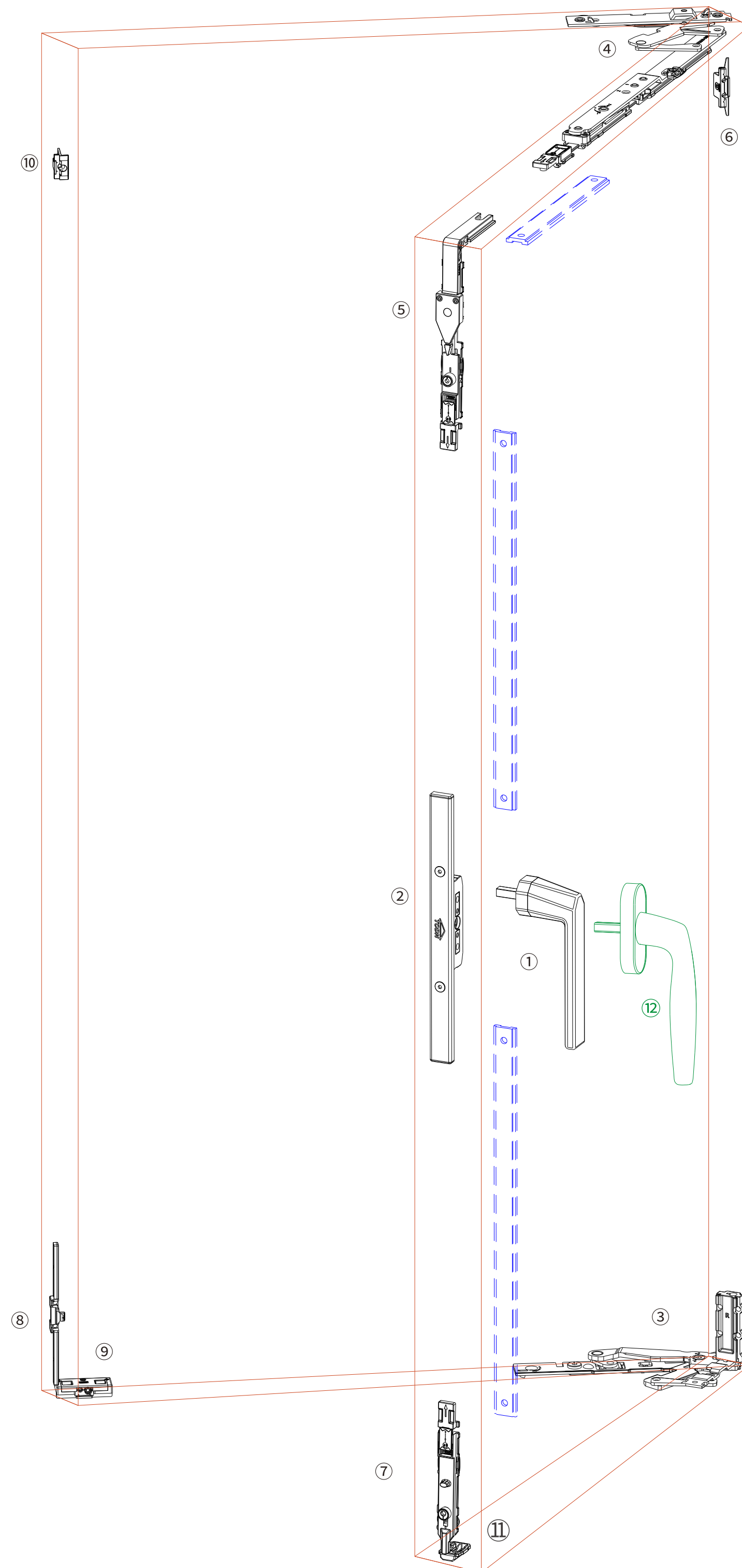

专利产品
Patented product

IND200 隐藏式内平开下悬系列

IND200 The Features for Concealed Turn-and-Tilt Window Series

序号/No.	名称/Name	型号/Code	数量/QTY	备注/Mark
1	无基座执手 Handle without base	IH00525	1	方钢外露25mm Exposed spindle length 25mm
2	传动器 Transmitter	IAG13	1	中心距13mm Center distance 13mm
3	下合页 Bottom hinge	IXH101AR	1	分左右 Left&Right
4	上合页拉杆 Upper hinge connector rod	ITDS01R	1	分左右 Left&Right
5	转角器 Corner device	ICD02	1	
6	锁座 Locking plate	IPDI01	1	
7	翻转支撑 Overturn Supporter	ICDT01	1	
8	防脱器 Fall arrester	IPDS01	1	
9	支撑座 Supporting block	ISCT03	1	
10	锁块 Locking plate	ILP02	1	
11	垫块 Cushion block	ICB02	1	
12	执手 Handle	IH00225	1	选配, 方钢外露25mm Optional, Exposed spindle length 25mm

配置说明:
Configuration Instruction

1. 本配置适用窗扇槽口高度为610mm-1900mm,窗扇槽口宽度450mm-720mm。窗高大于1300mm时,需增加转接杆。
This configuration is suitable for window sash notch height from 610mm to 1900mm, and window sash notch width from 450mm to 720mm. Connector rod need be increased when the window height is bigger than 1300mm.
2. 合页最大承重110kg,建议窗型比(高/宽)保持在1.5: 1。
The maximum load-bearing capacity of the hinge is 110kg, and it is recommended that the window ratio (height/width) be maintained at 1.5:1.
3. 窗扇最大开启角度为180°。
The maximum opening angle of the window sash is 180°.